

## Excavator Railroad Bypass Tie Grapples

Selecting the material from a stack will no longer be a problem because Moley Railroad Bypass Tie Grapples have the option between a straight blade or trowel, are entirely built with special high-strength steel and are applicable to any machinery.

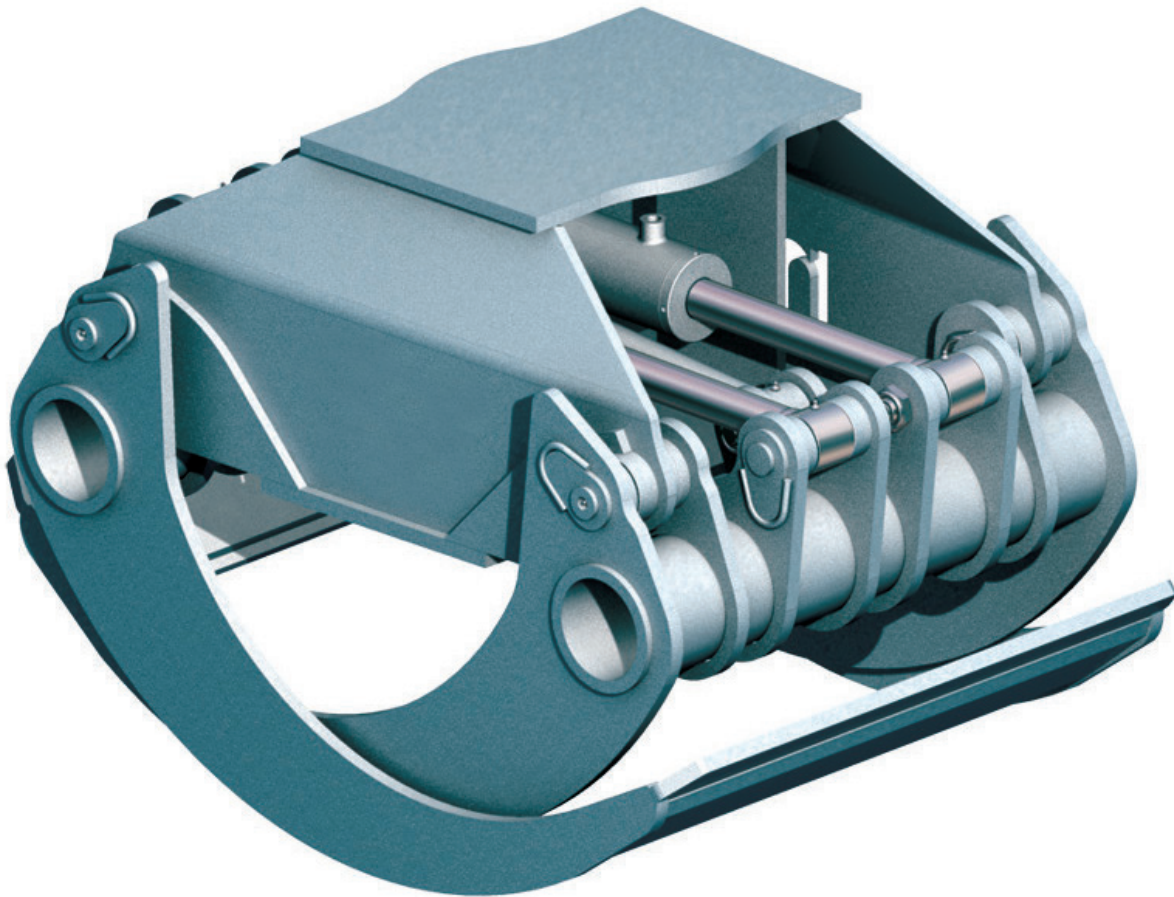

- 24-Month Warranty
- Hardened Shaft
- Wear Resistant Blade
- Safety Holding Valve
- Hardox 400 Construction
- 360° Rotation Available

## Excavator Railroad Bypass Tie Grapples (Con't)

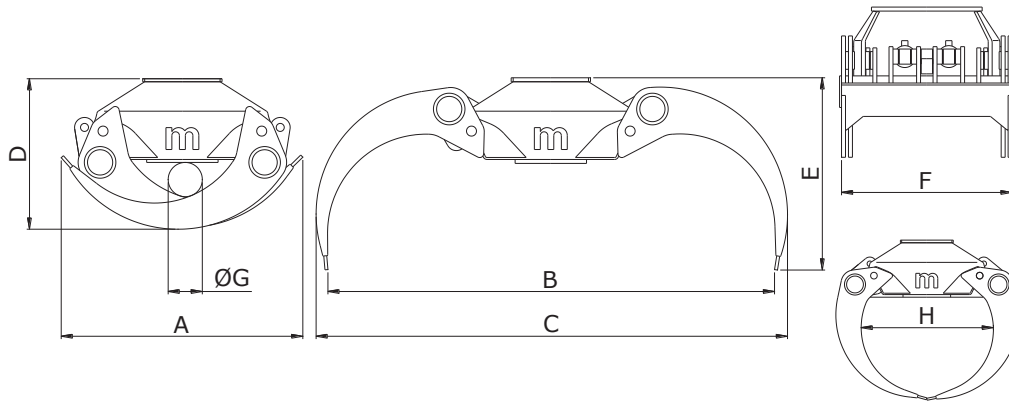

MODEL	SURFACE	WEIGHT	CYLINDERS	SIZES (in.)							
	yd <sup>3</sup>			LBS.	N	A	B	C	D	E	F
RBTG 15 W	0.08	220	1	27	46	48	19	24	16	4	18
RBTG 20 W	0.12	265	1	27	55	56	22	25	16	6	20
RBTG 25 W	0.16	507	1	35	64	67	24	31	20	4	26
RBTG 35 WL	0.27	661	1	41	74	79	28	34	20	6	29
RBTG 35 W	0.27	926	2	38	73	77	28	34	26	5	30
RBTG 60 WS	0.61	1543	2	47	89	96	32	39	31	7	34
RBTG 60 W	0.61	1587	2	47	89	96	32	39	34	7	34
RBTG 70 W	0.77	1653	2	54	100	104	34	38	34	8	40

MODEL	LOAD CAPACITY	FORCE	PRESSURE		REC OILFLOW		TIMES		MACHINE	TRUCK CRANE
	TONS	TONS	PSI		G/MIN		SEC		TONS	TONS
			CLOSE	OPEN	CLOSE	OPEN	CLOSE	OPEN		
RBTG 15 W	1.1	0.9	3626	3626	8	5	1.5	1	3-6	4-7
RBTG 20 W	1.1	0.8	3626	3626	8	5	1.5	1	3-6	4-7
RBTG 25 W	2.2	2.2	4351	4061	18	18	1.5	1	6-15	9-13
RBTG 35 WL	2.2	1.9	4351	4061	18	18	1.5	1	11-15	9-13
RBTG 35 W	2.75	2.75	4351	4061	26	26	1.5	1	15-23	13-15
RBTG 60 W / WS	4.4	4.0	4351	4061	48	48	1.5	1	20-31	-
RBTG 70 W	4.4	3.6	4351	4061	48	48	1.5	1	25-33	-

### Options

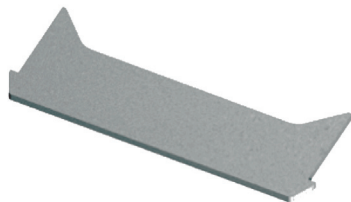

Straight Blade

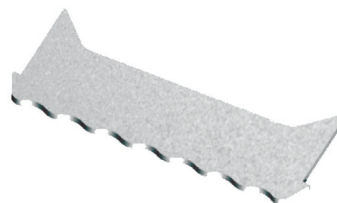

Toothed Blade